



TECHNICAL CHARACTERISTICS

- Low weight cast aluminum impeller and cast iron casing
- Smooth operation
- High efficiency impeller
- Maintenance free
- Mountable in any position

OPTIONS

- Special voltages (IEC 38)
- Surface treatments

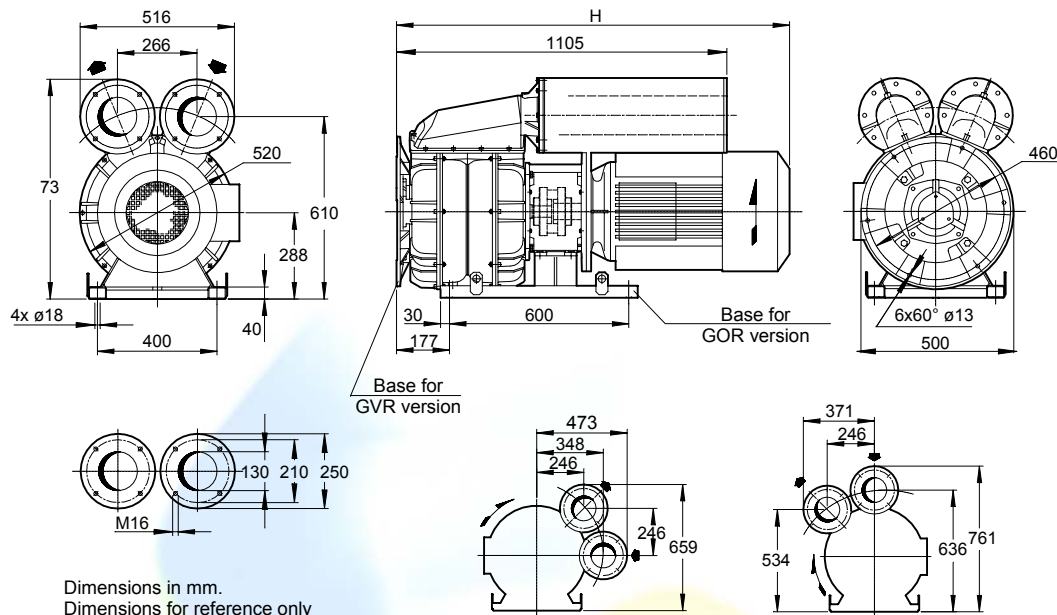

Dimensions in mm.
Dimensions for reference only

Model	Maximum flow m ³ /h		Installed power kW		Maximum differential pressure Δp hPa (mbar)		Noise level Lp dB (A) (1)		Overall dimensions H mm	Weight Kg	
	50 Hz 2900 rpm	60 Hz 3500 rpm	50 Hz 2900 rpm	60 Hz 3500 rpm	50 Hz 2900 rpm	60 Hz 3500 rpm	50 Hz 2900 rpm	60 Hz 3500 rpm		GOR	GVR
115DH	1112	1341	11.0	11.0	200	125	93.8	96.8	1200	385	358
			15.0	15.0	300	225	94.1	97.1	1200	385	358
			18.5	18.5	400	275	94.4	97.4	1200	400	373
			22.0	22.0	500	375	94.7	97.7	1255	460	433
			30.0	30.0	600	600	95.0	98.0	1290	525	499

(1) Noise measured at 1 m distance with inlet and outlet ports piped, in accordance to ISO 3744.

- For proper use, the blower should be equipped with inlet filter and safety valve; other accessories available on request.
- Ambient temperature from -15° to +40°C.
- Specifications subject to change without notice.

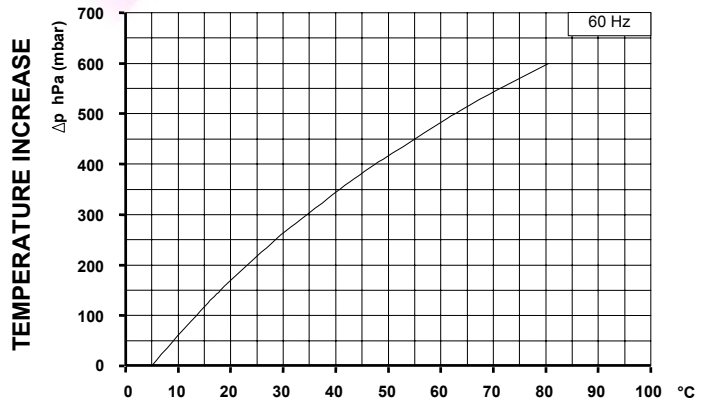
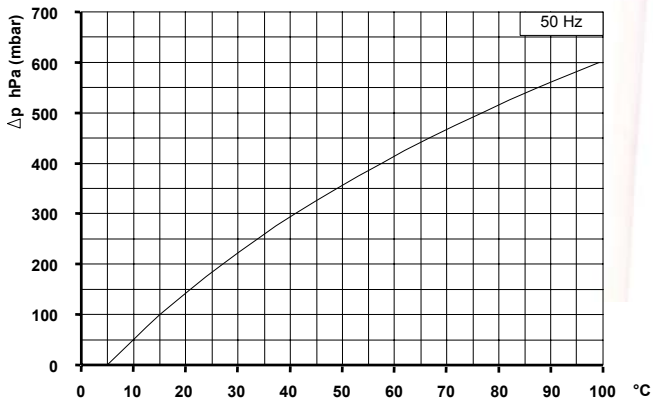
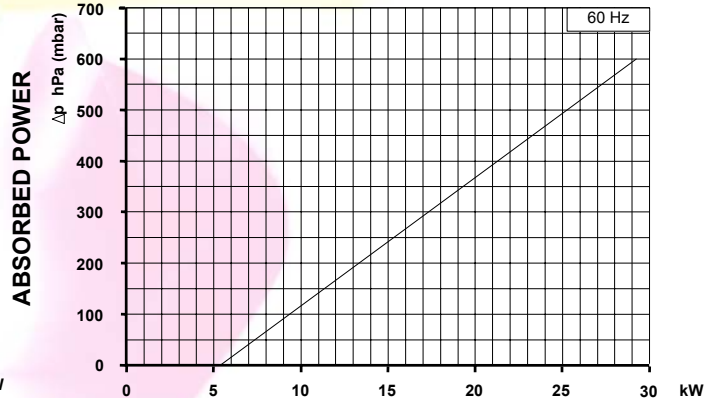
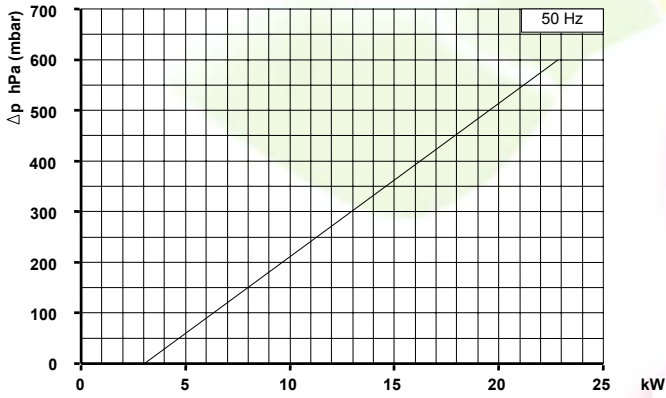
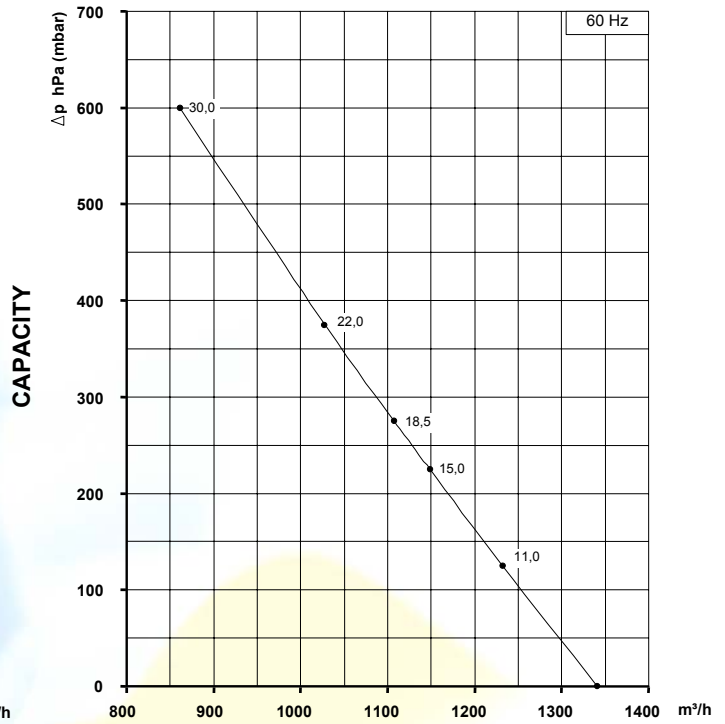
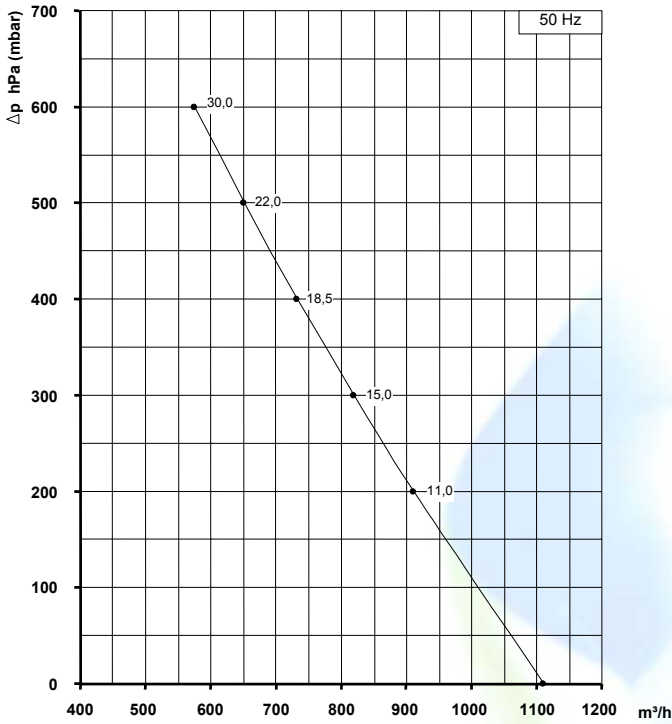

Curves refer to air at 20°C temperature and 1013 mbar (abs) atmospheric pressure measured at inlet port.
 Values for flow, power consumption and temperature rise: +/-10% tolerance.
 Data can change without prior notice.