

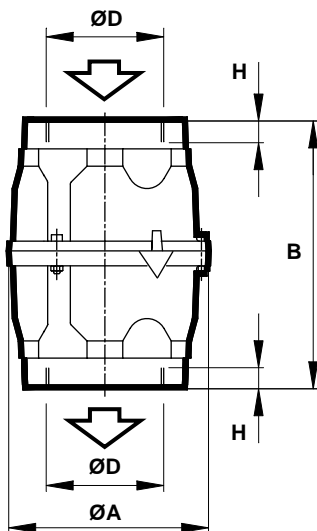

The valves have been designed for low pressure / vacuum range with minimal hysteresis (difference between the value at which the valve start to open and the value at which the valve is fully opened). The valves are supplied with different springs to maximise their efficiency. These compact valves made of aluminium alloy, are both easy to install and set-up. Valves are designed to operate in a wide range of capacities. They are featured to divert an excess of primary flow through an external pipe when working in pressure conditions, and to pipe-in a secondary flow when working in vacuum conditions. Maximum efficiency is achieved keeping operating values (flow capacity to the relative setting pressure / vacuum value) within the **operating range** that refers to air having density equal to 1,23 kg/m<sup>3</sup>.

### OPERATION RANGE

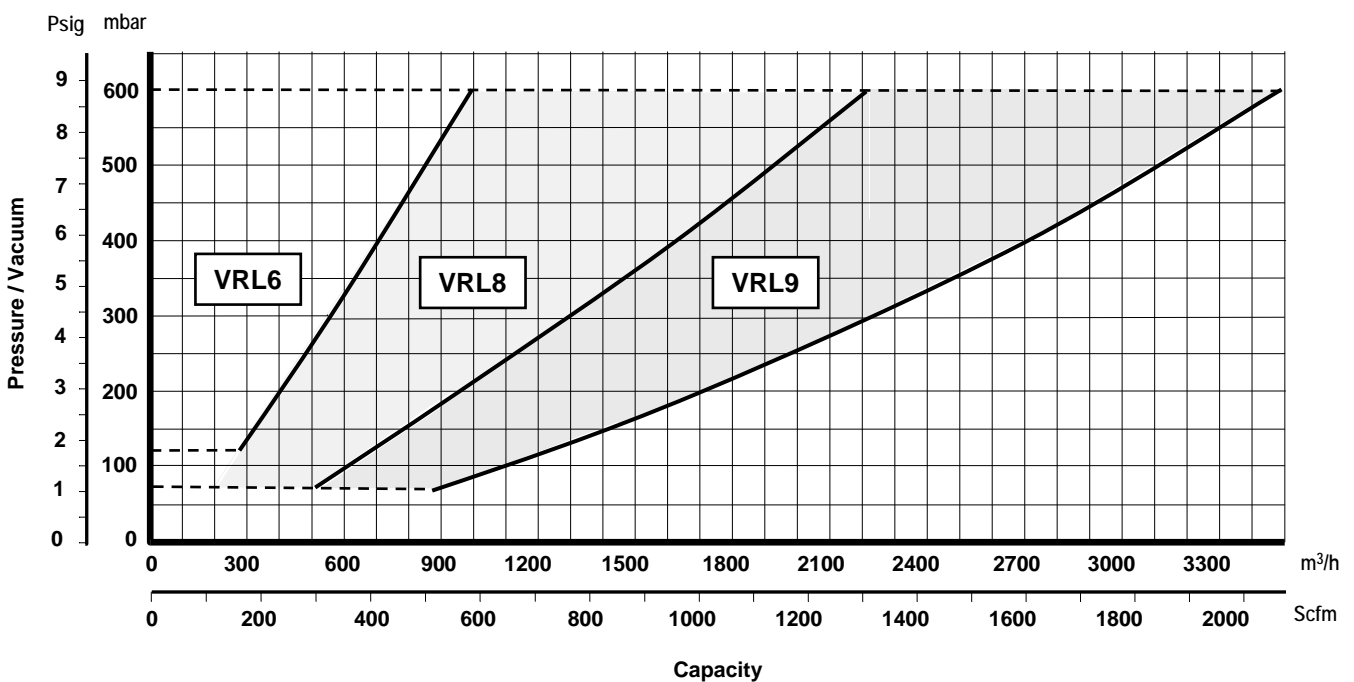

### OVERALL DIMENSIONS

TYPE	DN	D	A	B	H	WEIGHT (Kg)
VRL6	50	G 2"	102	175	12	0.85
VRL8	80	G 3"	135	190	15	1.90
VRL9	100	G 4"	160	206	18	2.60